

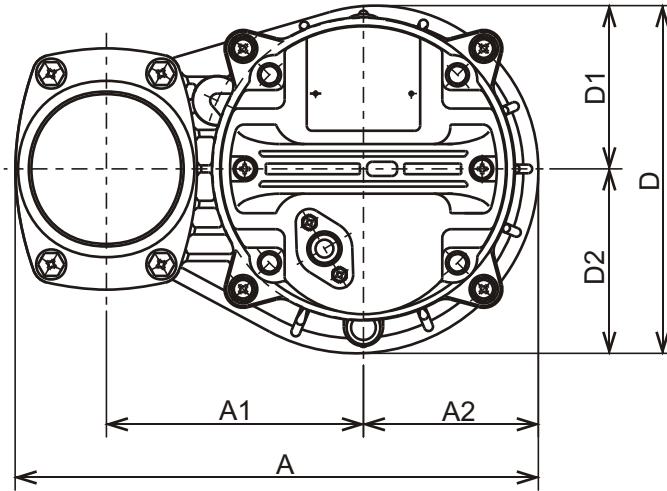

**VANCS - SERIES - PSF**  
(FRP) EFFLUENT PUMPS

**DIMENSIONS**



**80PSF21.5-62**

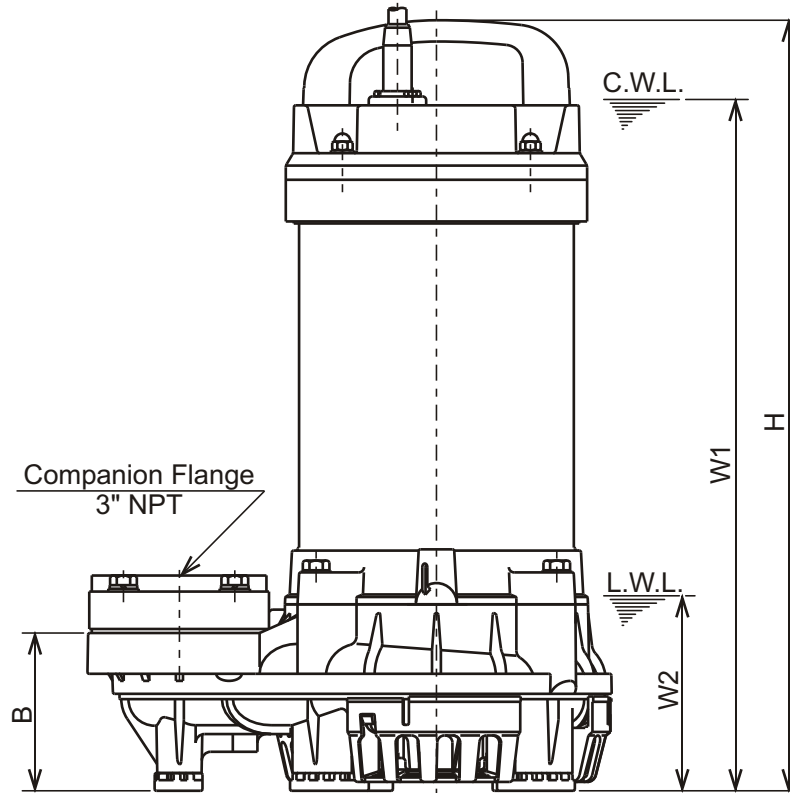

C.W.L. : Continuous running Water Level  
L.W.L. : Lowest running Water Level

**DIMENSIONS:USCS (In ch)**

Model	HP	NOM. SIZE	Pump & Motor								C.W.L. W1	L.W.L. W2	Wt. (lbs.)
			A	A1	A2	B	D	D1	D2	H			
80PSF21.5-62	2	3"	11 5/8	5 11/16	3 7/8	3 1/2	7 11/16	3 5/8	4 1/8	17 1/8	15 3/8	4 3/8	35.2

**DIMENSIONS:METRIC (mm)**

Model	kW	NOM. SIZE	Pump & Motor								C.W.L. W1	L.W.L. W2	Wt. (kg)
			A	A1	A2	B	D	D1	D2	H			
80PSF21.5-62	1.5	80	295	145	99	89	196	92	104	435	390	110	16.0